



1/2 HP ECONOMY

2 YEAR WARRANTY

MASTER EDITION

Easy and Fast to Install

WASTEMAID disposers feature Speed Master Mounting, an exclusive system that provides fast and economical installation.

Corrosion Proof

The WASTEMAID 058 carries a lifetime warranty against failure due to corrosion.

Permanent Magnet Motors

WASTEMAID motors offer maximum torque instantly with the power to cut through potential jams.

Compact and Lightweight

The compact design of your WASTEMAID allows inclusion where limited under counter space is available.

Removable Splash Guard

All WASTEMAID models have a removable splash guard, ideal for easy cleaning and replacement.



BIO SHIELD (Antimicrobial) for **ODOR PROTECTION!** Disposers are treated with an antimicrobial agent molded inside providing protection against odor causing bacteria growth.



THE TORQUE MASTER GRINDING SYSTEM is a combination of computer designed and balanced components working in unison to provide superior torque grind speed and long system life.

SPECIFICATIONS

MODEL #058

HORSEPOWER	1/2 HP
MOTOR SPEED RPM	2600 RPM
VOLTAGE	220-240v
WATTAGE	375
AMPS	2.25
CYCLES	50/60
MOTOR TYPE	Permanent Magnet
SPLASH GUARD	EPDM Rubber
DRAIN OUTLET	Polycarbonate 940
GRIND RING	Stainless Steel
SWIVEL IMPELLERS	Stainless Steel
BALANCED TURNTABLE	Stainless Steel
BALANCED ARMATURE SHAFT	Stainless Steel
HOPPER	ABS
DRAIN HOUSING	Thermoset polymer
APPLIANCE PROTECTOR	Manual Reset
SINK FLANGE	Polyamide 66
STOPPER	Polypropylene
BEARINGS	Permanently Lubricated, Sleeve Type
SINK WASTE	90mm
INDIVIDUAL SHIPPING WEIGHT	4.3 KG
MASTER CARTON WEIGHT (4 UNITS)	18 KG
MEASUREMENT A	354 MM
MEASUREMENT B	161 MM
MEASUREMENT C	132 MM
MEASUREMENT D	137 MM
MEASUREMENT E	70 MM
LIFETIME CORROSION GUARANTEE	Yes

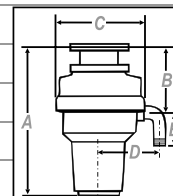

ANAHEIM (UK) LIMITED

TEL: +44 (0) 1483 572 294

Email: ContactUs@AnaheimUK.com

www.WasteMaid.co.uk

All Waste Maid Disposers are compliant with the EC Directive regards RoHS.