



1/2 HP STANDARD

3 YEAR WARRANTY



BIO SHIELD (Antimicrobial) for **ODOR PROTECTION!** Disposers are treated with an antimicrobial agent molded inside providing protection against odor causing bacteria growth.



THE TORQUE MASTER GRINDING SYSTEM is a combination of computer designed and balanced components working in unison to provide superior torque grind speed and long system life.

## MASTER EDITION

### Easy and Fast to Install

WASTEMAID disposers feature Speed Master Mounting, an exclusive system that provides fast and economical installation.

### Corrosion Proof

The WASTEMAID 158 carries a lifetime warranty against failure due to corrosion.

### Permanent Magnet Motors

WASTEMAID motors offer maximum torque instantly with the power to cut through potential jams.

### Compact and Lightweight

The compact design of your WASTEMAID allows inclusion where limited under counter space is available.

### Removable Splash Guard

All WASTEMAID models have a removable splash guard, ideal for easy cleaning and replacement.

## SPECIFICATIONS

## MODEL #158

|                                       |                                     |
|---------------------------------------|-------------------------------------|
| <b>HORSEPOWER</b>                     | 1/2 HP                              |
| <b>MOTOR SPEED RPM</b>                | 2600 RPM                            |
| <b>VOLTAGE</b>                        | 220-240v                            |
| <b>WATTAGE</b>                        | 450                                 |
| <b>AMPS</b>                           | 2.25                                |
| <b>CYCLES</b>                         | 50/60                               |
| <b>MOTOR TYPE</b>                     | Permanent Magnet                    |
| <b>SPLASH GUARD</b>                   | EPDM Rubber                         |
| <b>DRAIN OUTLET</b>                   | Polycarbonate 940                   |
| <b>GRIND RING</b>                     | Stainless Steel                     |
| <b>SWIVEL IMPELLERS</b>               | Stainless Steel                     |
| <b>BALANCED TURNTABLE</b>             | Stainless Steel                     |
| <b>BALANCED ARMATURE SHAFT</b>        | Stainless Steel                     |
| <b>HOPPER</b>                         | ABS                                 |
| <b>DRAIN HOUSING</b>                  | Thermoset polymer                   |
| <b>APPLIANCE PROTECTOR</b>            | Manual Reset                        |
| <b>SINK FLANGE</b>                    | Polyamide 66                        |
| <b>STOPPER</b>                        | Polypropylene                       |
| <b>BEARINGS</b>                       | Permanently Lubricated, Sleeve Type |
| <b>SOUND SHELL</b>                    | Partial                             |
| <b>SINK WASTE</b>                     | 90 MM                               |
| <b>INDIVIDUAL SHIPPING WEIGHT</b>     | 4.4 KG                              |
| <b>MASTER CARTON WEIGHT (4 UNITS)</b> | 18.6 KG                             |
| <b>MEASUREMENT A</b>                  | 354 MM                              |
| <b>MEASUREMENT B</b>                  | 161 MM                              |
| <b>MEASUREMENT C</b>                  | 132 MM                              |
| <b>MEASUREMENT D</b>                  | 137 MM                              |
| <b>MEASUREMENT E</b>                  | 70 MM                               |
| <b>LIFETIME CORROSION GUARANTEE</b>   | Yes                                 |

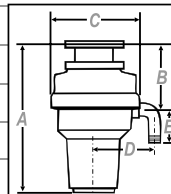

ANAHEIM (UK) LIMITED

TEL: +44 (0) 1483 572 294

Email: ContactUs@AnaheimUK.com

www.WasteMaid.co.uk

All Waste Maid Disposers are compliant with the EC Directive regards RoHS.